

## Delegation Guide for Foundry's Near Validators

Delegating NEAR From 3rd-Party Custodian Wallets or Self-Custody Wallets

### Guide Objectives

Learn how to quickly and easily stake NEAR holdings and begin earning rewards.

Learn how to unstake or withdraw your staked NEAR.

Learn how to monitor key staking information for your staked NEAR.

### Key Information

- ✓ 9% fees ONLY on earned rewards
- ✓ US-based validators, open delegation
- ✓ Top 6 NEAR validator by staked size
  - Cumulative ~19M NEAR tokens entrusted to earn rewards with us
  - [NEAR Staking Validator Explorer](#)

**Foundry's NEAR Validator**

**Name: FOUNDRY.POOLV1.NEAR**

### Key Assumptions

- ✓ NEAR tokens are already held within a 3rd-party custody wallet OR self-custody wallet within the NEAR application.

## Objective 1: Staking Your Near

### Step 1: Create an account with NEAR or import an existing account.

- 1A Navigate to [wallet.near.org](https://wallet.near.org).
- 1B Access your account using your:
  - Ledger hardware device (only compatible with Firefox browsers)
  - 12-word seed phrase
  - Email address
  - Phone number

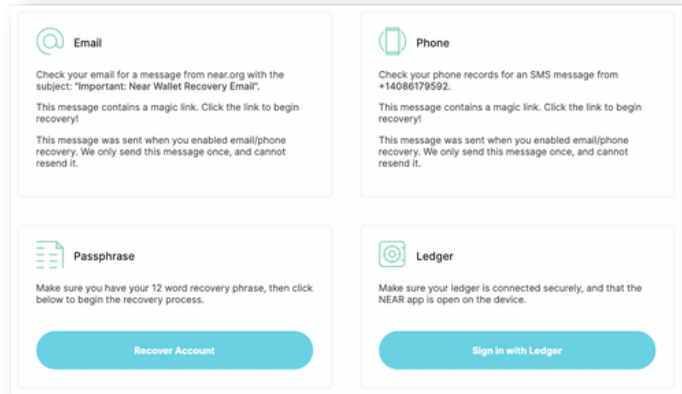

### Step 2: Stake with Foundry's Validator

- 2A Select "Staking" from the navigation bar (dropdown for mobile).
- 2B Click on the "Select Validator" button.
- 2C Choose [foundry.poolv1.near](https://foundry.poolv1.near).
- 2D Confirm by selecting "Stake with Validator."
- 2E Enter your desired amount of NEAR to stake, and click "Submit Stake."
- 2F This process requires you to confirm two transactions:
  - One to select the validator
  - One to deposit with and stake to Foundry's validator

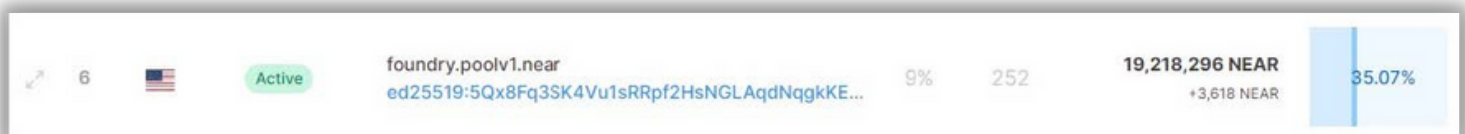

## Objective 2: Unstaking Your Near

---

**Step 1:** In your NEAR dashboard, select your current validator.

**Step 2:** Click "Unstake" and confirm the transaction.

- 2A** NOTE: It may take up to ~52-65 hours (4 epochs) to be able to withdraw your stake.
  - NEAR documentation at [near-node.io](https://near-node.io) states it takes ~36-48 hours (3 full epochs) before you may withdraw your stake.
  - Withdrawal timing may depend on timing of the withdrawal request.
- 2B** Return to the validator page.
- 2C** Click "Withdraw."

### Unstake All

Unstaking takes 2-3 epochs to complete. After the unstaking period, you may withdraw your NEAR from staking pool.

```
near call <stakingPoolId> unstake_all --accountId <accountId> --gas=300000000000000
```

## Objective 3: Monitoring Staked Near & Accessing Crucial Info

---

Within the NEAR Wallet interface, there is crucial information to make informed staking decisions.

These include:

- ✓ Total amount staked
- ✓ Unclaimed rewards
- ✓ Tokens available for withdrawal
- ✓ Tokens pending release
- ✓ Validator fees



## 1. Total Amount Staked

- 1A The amount of NEAR tokens your account is currently staking with a validator.
- 1B Tokens are continuously accumulating, and compounding rewards every epoch (~12 hours).
- 1C To access the tokens, you must unstake them.
  - Takes ~36-48 hours or 3 epochs.
  - You may then withdraw them from the staking pool.

## 2. Unclaimed Rewards

- 2A Token rewards earned but not withdrawn from a staking pool.
- 2B Automatically restaked
  - Increases over time
  - Rewards continuously compound every ~12 hours

## 3. Tokens Available for Withdrawal

- 3A Tokens already unstaked and ready to be withdrawn.

## 4. Tokens Pending Release

- 4A Tokens already unstaked but not ready to be withdrawn.
  - Available ~36-48 hours after unstaking

## 5. Validator Fees

- 5A Fees paid to a validator to stake on your behalf.
- 5B NOTE: Fees are ONLY charged on earned rewards.
  - No fees on the total NEAR balance staked.
- 5C Foundry's NEAR Validator fee is set to 9%, which is less than the typical NEAR validator fee.
  - The typical NEAR validator fee is 10%.

**Image  
Placeholder**

**Need vertical  
screenshot that  
applies to one  
of the steps on  
the left OR two  
separate  
screenshots.**

## Foundry Validator Earnings Comparison Example

	Tokens Delegated	Earned Rewards (10% APY of tokens delegated)	Total Fee % (only on earned rewards)	Total Client Rewards (earned less fee %)	Total Tokens with Reward	The Foundry Rewards Difference
<b>Foundry NEAR Validator</b>	<b>100</b>	<b>10</b>	<b>9%</b>	<b>9.1</b>	<b>109.1</b>	<b>+1.1%</b>
Typical NEAR Validator	100	10	10%	9	109	

### Helpful Information

- ✓ NEAR protocol static inflation rate of 5%/year.
- ✓ New tokens rewards for validators are distributed every epoch (~12 hours).

**For questions, please reach out to [staking@foundrydigital.com](mailto:staking@foundrydigital.com).**